

# Lower Thames Crossing

## 9.16 OFH2 action point 2 - Additional cross sections

Infrastructure Planning (Examination  
Procedure) Rules 2010:

Volume 9

**DATE: July 2023**  
**DEADLINE: 1**

Planning Inspectorate Scheme Ref: TR010032  
Examination Document Ref: TR010032/EXAM/9.16

**VERSION: 1.0**

# Lower Thames Crossing

## 9.16 OFH2 action point 2 - Additional cross sections

### List of contents

	Page number
<b>1 Introduction .....</b>	<b>1</b>
1.1 Response to Open Floor Hearing 2 action point 2 .....	1

## List of tables

	<b>Page number</b>
Table 1.1 OFH2 action point 2 .....	1
Table 1.2 Vertical sections requested .....	2
Table 1.3 List of relevant documents .....	4

# 1 Introduction

## 1.1 Response to Open Floor Hearing 2 action point 2

- 1.1.1 The Applicant writes to provide an update on progress with action point 2 (contained within Table 1.1 below) from Open Floor Hearing 2 Action List [EV-036], and to seek further guidance and instruction from the Examining Authority on whether or not the provision of additional cross-sectional information over and above that requested would be helpful at Deadline 2

**Table 1.1 OFH2 action point 2**

No	Party	Action	Deadline
2	Applicant	<p>Please provide vertical cross sections within the A13/ A1089/ LTC Baker Street intersection at the locations shown on the annotated version of the Junction Layout Plans [PDB003] provided by the ExA (linked as [EV-035]).</p> <p>In addition, please provide vertical cross sections within the A2 / M2/ LTC intersection and the M25 / LTC intersection as identified by the ExA in [EV-035]. While the latter were not specifically identified by participants at OFH2, the issue of vertical cross section plans generally was raised in earlier hearings and the ExA has decided to make a combined request addressing each of the main intersections in preference, providing a consistent set of sections drawings. The applicant should advise on progress by Deadline 1 and is encouraged to seek further guidance from the ExA on the production of these sections if necessary at that time.</p>	D2 (D1 for further guidance)

- 1.1.2 The Applicant notes the above action point from OFH2 for cross sections of the following three junctions, to be prepared for Deadline 2:
- a. A2/ M2/LTC – 2x cross sections requested (A&B)
  - b. A13/ A1089 / LTC – 5x cross sections requested (C-G)
  - c. M25 / LTC – 2x cross sections requested (H&J)
- 1.1.3 The Applicant notes the location of the 9x cross sections that are defined by the annotated version of the Junction Layout Plan [EV-035] and listed as follows:

**Table 1.2 Vertical sections requested**

Section	Location/Sheet	Notes
A - A	A2/ M2/ LTC Intersection at Thong	From Astra Drive to HS1
B - B	A2/ M2/ LTC Intersection at Thong	From Thong Lane to Jeskyns
C - C	A13/ A1089/ LTC Intersection at Baker Street	Along centre line of proposed slip from LTC southbound to Orsett Cock
D - D	A13/ A1089/ LTC Intersection at Baker Street	Along Stifford Clays Road
E - E	A13/ A1089/ LTC Intersection at Baker Street	From Baker Street to south of existing A13 mainline
F - F	A13/ A1089/ LTC Intersection at Baker Street	From Woolings Close to west of Stanford Road
G - G	A13/ A1089/ LTC Intersection at Baker Street	From north of A13 to Stanford Road
H - H	M25/ LTC Intersection at North Ockendon	From Pike Land Ockendon
J - J	M25/ LTC Intersection at North Ockendon	From Dennis Road to FP252 / FP151

- 1.1.4 With the exception of C – C (which follows the centre of the proposed slip), all other sections are straight line sections.
- 1.1.5 We can confirm that we have commenced work on this action point, and we are on track to complete this request by Deadline 2.
- 1.1.6 We propose that the form of these cross sections will be similar in appearance to those shown in the Engineering Drawings and Sections (Volume B) (A122 LTC cross sections) [[APP-031](#)]. An example is shown below:

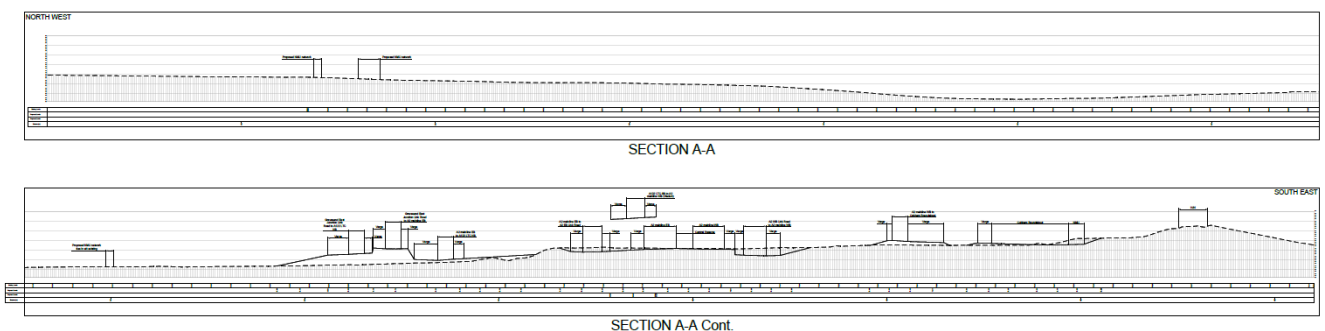

- 1.1.7 Furthermore, the Applicant proposes that in addition to the 9x cross sections requested by the ExA, some additional cross sections be provided at Deadline 2, in a format which provides a little more context. An example of these is shown below:

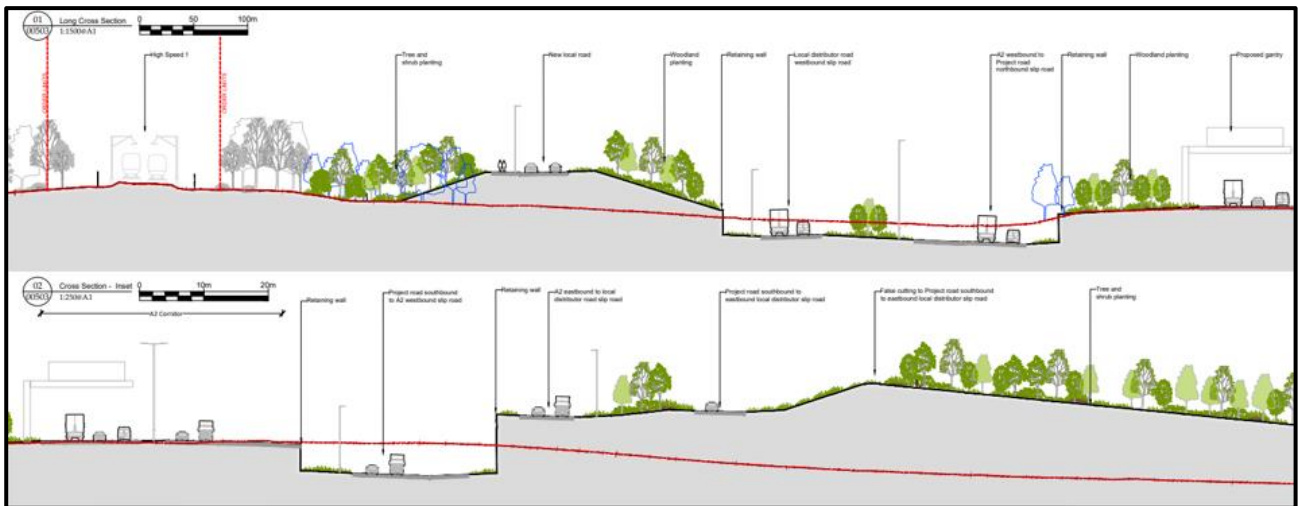

- 1.1.8 Finally, the Applicant wishes to signpost to the following information that is already available within the application which may assist Interested Parties in understanding the form of the three main junctions.
- 1.1.9 The junctions are shown in a plan view on the General Arrangement Plans [APP-015; APP-016; APP-017] and the Works Plans [APP-018; AS-024; AS-026]. All the highways works are identified as a numbered work in Schedule 1 of the draft Development Consent Order [AS-038]. Under Section 13.2 of the Introduction to the Application [APP-003] it is explained how the numbered works were defined and Plates 13.1 and 13.2 provide further clarity for highways works at the M2/A2/A122 Lower Thames Crossing junction and the A13/A1089/A122 Lower Thames Crossing junction.
- 1.1.10 In addition, all highways works are shown in the Engineering Drawings and Sections where the Applicant presents a plan and a profile for each proposed road. This set has been divided into different volumes for ease of use: Volume A shows the plan and profile of the proposed A122 Lower Thames Crossing mainline alignment [APP-030]; Volume D shows the plan and profile of the proposed roads in the M2/A2/A122 Lower Thames Crossing junction [APP-033]; Volume F shows the plan and profile of the proposed roads in the A13/A1089/A122 Lower Thames Crossing junction [APP-035]; and Volume G shows the plan and profile of the proposed roads in the A122 Lower Thames Crossing/M25 junction [APP-036]. The profiles represent the proposed levels for each road, the finished road level at structures and indicates the associated work number for ease of correspondence with the Works Plans and Schedule 1 of the draft Development Consent Order [AS-038]. Further detail on the proposed structures is presented in the Structures Plans [APP-043 and APP-044].
- 1.1.11 Further textual description of all highways works is given in Environmental Statement Chapter 2: Project Description [APP-140] and the rationale for the design is thoroughly explained in the Project Design Report, namely in Parts D for junctions design – General Design South of the River [APP-509], General Design North of the River - North of the A13 Junction to the M25 [APP-510] and General Design North of the River - Tilbury to the A13

Junction [[APP-511](#)] and in Part F: Structures and Architecture for further detail on structures design [[APP-513](#)].

- 1.1.12 The Environmental Statement photomontages provide additional clarity on the proposed structures visual representation [[APP-244](#), [APP-245](#), [APP-246](#) and [APP-247](#)].

**Table 1.3 List of relevant documents**

Document title	Examination Library reference number
2.5 General Arrangement Plans	<a href="#">APP-015</a> <a href="#">APP-016</a> <a href="#">APP-017</a>
2.6 Works Plans (composite version)	<a href="#">APP-018</a> <a href="#">AS-024</a> <a href="#">AS-026</a>
Schedule 1 of 3.1 draft DCO	<a href="#">AS-038</a>
2.9 Engineering Drawings and Sections	<a href="#">APP-030</a> <a href="#">APP-033</a> <a href="#">APP-035</a> <a href="#">APP-036</a>
2.13 Structures Plans	<a href="#">APP-043</a> <a href="#">APP-044</a>
6.1 Environmental Statement - Chapter 2 - Project Description	<a href="#">APP-140</a>
7.4 Project Design Report	<a href="#">APP-509</a> <a href="#">APP-510</a> <a href="#">APP-511</a> <a href="#">APP-513</a>
6.2 Environmental Statement - Figure 7.19 - Photomontages - Winter Year 1 and Summer Year 15	<a href="#">APP-244</a> <a href="#">APP-245</a> <a href="#">APP-246</a> <a href="#">APP-247</a>

If you need help accessing this or any other National Highways information, please call **0300 123 5000** and we will help you.

© Crown copyright 2023.

You may re-use this information (not including logos) free of charge in any format or medium, under the terms of the Open Government Licence. To view this licence:

visit [www.nationalarchives.gov.uk/doc/open-government-licence/](http://www.nationalarchives.gov.uk/doc/open-government-licence/)

write to the **Information Policy Team, The National Archives, Kew, London TW9 4DU**, or email [psi@nationalarchives.gsi.gov.uk](mailto:psi@nationalarchives.gsi.gov.uk).

Mapping (where present): © Crown copyright and database rights 2022 OS 100030649. You are permitted to use this data solely to enable you to respond to, or interact with, the organisation that provided you with the data. You are not permitted to copy, sub-licence, distribute or sell any of this data to third parties in any form.

If you have any enquiries about this publication email [info@nationalhighways.co.uk](mailto:info@nationalhighways.co.uk) or call **0300 123 5000**.\*

\*Calls to 03 numbers cost no more than a national rate call to an 01 or 02 number and must count towards any inclusive minutes in the same way as 01 and 02 calls.

These rules apply to calls from any type of line including mobile, BT, other fixed line or payphone. Calls may be recorded or monitored.

Printed on paper from well-managed forests and other controlled sources when issued directly by National Highways.

Registered office Bridge House, 1 Walnut Tree Close, Guildford GU1 4LZ

National Highways Company Limited registered in England and Wales number 09346363